

ENGAGE IPTV CONSOLE

ASSEMBLY ADDENDUM

M051-00K88-0009 REV B

This addendum provides information on specific assembly required for Engage IPTV Console installations on the following equipment:

- 95T Treadmill
- 95X Cross-Trainer
- 97C and 95C Upright Lifecycle® Exercise Bike
- 95R Recumbent Lifecycle® Exercise Bike

IPTV uses Internet Protocol (IP) Ethernet cabling and signals to provide TV programs and videos. **Verify with the customer's AV System Integrator that one of the following kits has been delivered and properly installed:**

- IPTV-HDMITX-KIT
- IPTV-HDMITX-KITBR

Successful IPTV Engage Console Installation requires the following:

- Verify or Install Shielded CAT5e Cable (AK70-00092-0000)
- Verify or Install Shielded RJ-45 Coupler (*bikes and cross-trainers only*)
- Install Ferrite on the base's CAT5e Cable
- Connect the Shielded CAT5e Cable to the Engage Console
- Adjust HDMI Receiver Signal Sensitivity in Engage Console
- Set the IPTV setting to match Set-Top-Box Manufacturer

Shielded CAT5e Cable Installation

The IPTV system requires a SHIELDED CAT5e Cable between the console and the Shielded RJ-45 Coupler on the base units.

Shielded CAT5e Cable



Note: The connector is partially METAL.

8-Conductor Wire



Note: The connector is ALL PLASTIC.

Identify the type of cable plugged into the RJ-45 Coupler on the base units. Common cables include:

- Shielded CAT5e Cable (AK70-00092-0000)
- 65-inch, 8-conductor, Flat Phone Cable (AK65-00051-0001) plugged into the RJ-45 coupler ***(treadmills and cross-trainers)***
- 90-inch, 8-conductor, CAT-5 Cable (AK32-00019-0001) plugged into the RJ-45 coupler ***(upright and recumbent bikes)***

If the existing cable is NOT a Shielded CAT5e Cable replace it with a Shielded CAT5e Cable. Pull the Shielded CAT5e Cable through the base unit by tying it to the existing wire.

Note: *It may be necessary to remove a shroud or perform other disassembly if the Shielded CAT5e Cable gets caught, snagged, etc.*

Shielded RJ-45 Coupler



BLACK PLASTIC RJ-45 COUPLER



METAL SHIELDED RJ-45 COUPLER

Bikes and Cross-Trainers have one of the following Couplers in the base unit:

- Black Plastic RJ-45 Coupler
- Metal Shielded RJ-45 Coupler

If the base has a metal shielded RJ-45 Coupler (0017-00021-3195), then nothing needs to be done with the coupler.

If the base has a black plastic RJ-45 Coupler, follow these steps to replace it with the metal shielded RJ-45 Coupler (included in the bike and cross-trainer consoles):

1. Loosen the lower shroud(s) to gain access to the inside of the Panel Assembly.
Note: You may need to remove a pedal on the bike to gain access.
2. Press the tab on the black plastic RJ-45 Coupler and push it through the hole towards the inside of the Panel Assembly.
3. Disconnect the CAT5e Cable on the inside.
4. Press the metal shielded RJ-45 Coupler from the inside until it snaps into place.
5. Reconnect the internal CAT5e Cable.



Secure Ferrite on the Shielded CAT5e Base Cable

1. Locate the ferrite in the accessory box (*bikes and cross-trainers*) or bag (*treadmills*).
2. Position the ferrite approximately 5 inches from the end of the Shielded CAT5e Cable.
3. Snap the ferrite closed around the cable.
4. Place cable ties on either side of the ferrite to hold the ferrite in place.
5. Pull the cable ties tight and cut off excess.

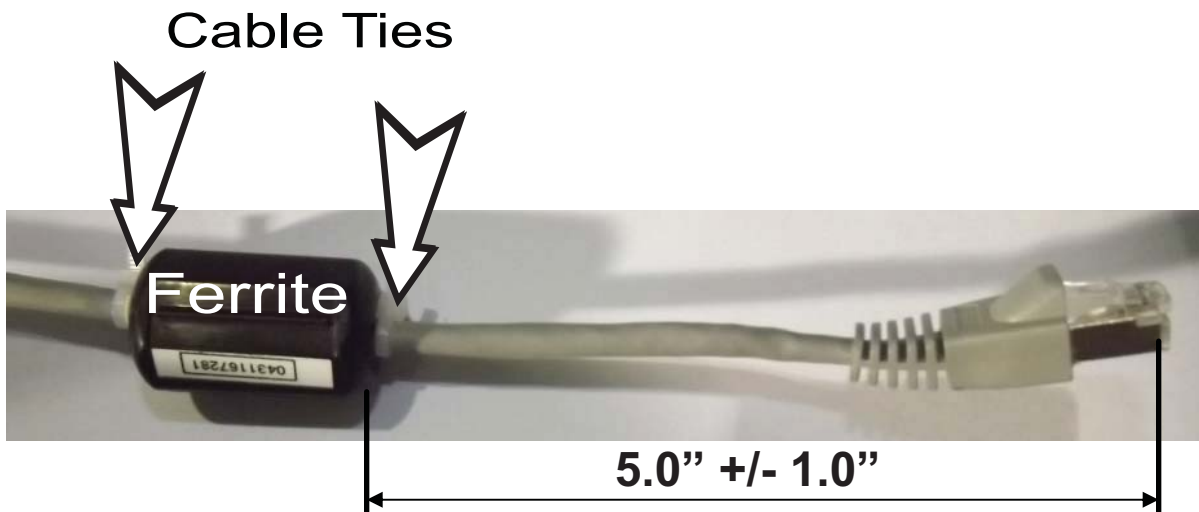

Connect CAT5e Cable to Engage Console

BIKES and CROSS-TRAINERS

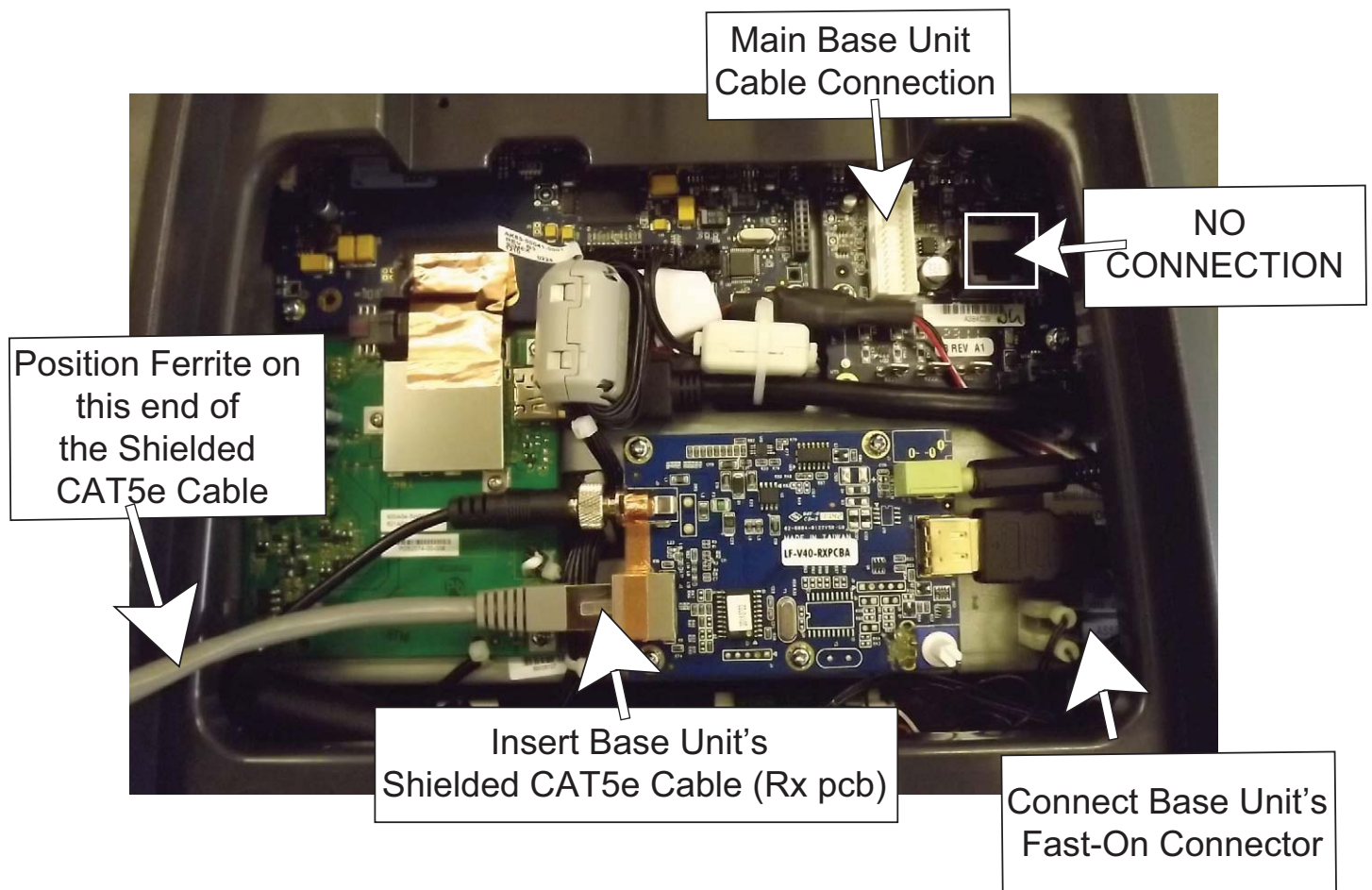

CAT5e Cable Connection to Engage Console

TREADMILLS

Note: The CSAFE Extension Cable still plugs into the MIB and goes to the 2:1 RJ-45 Splitter on the bridge.

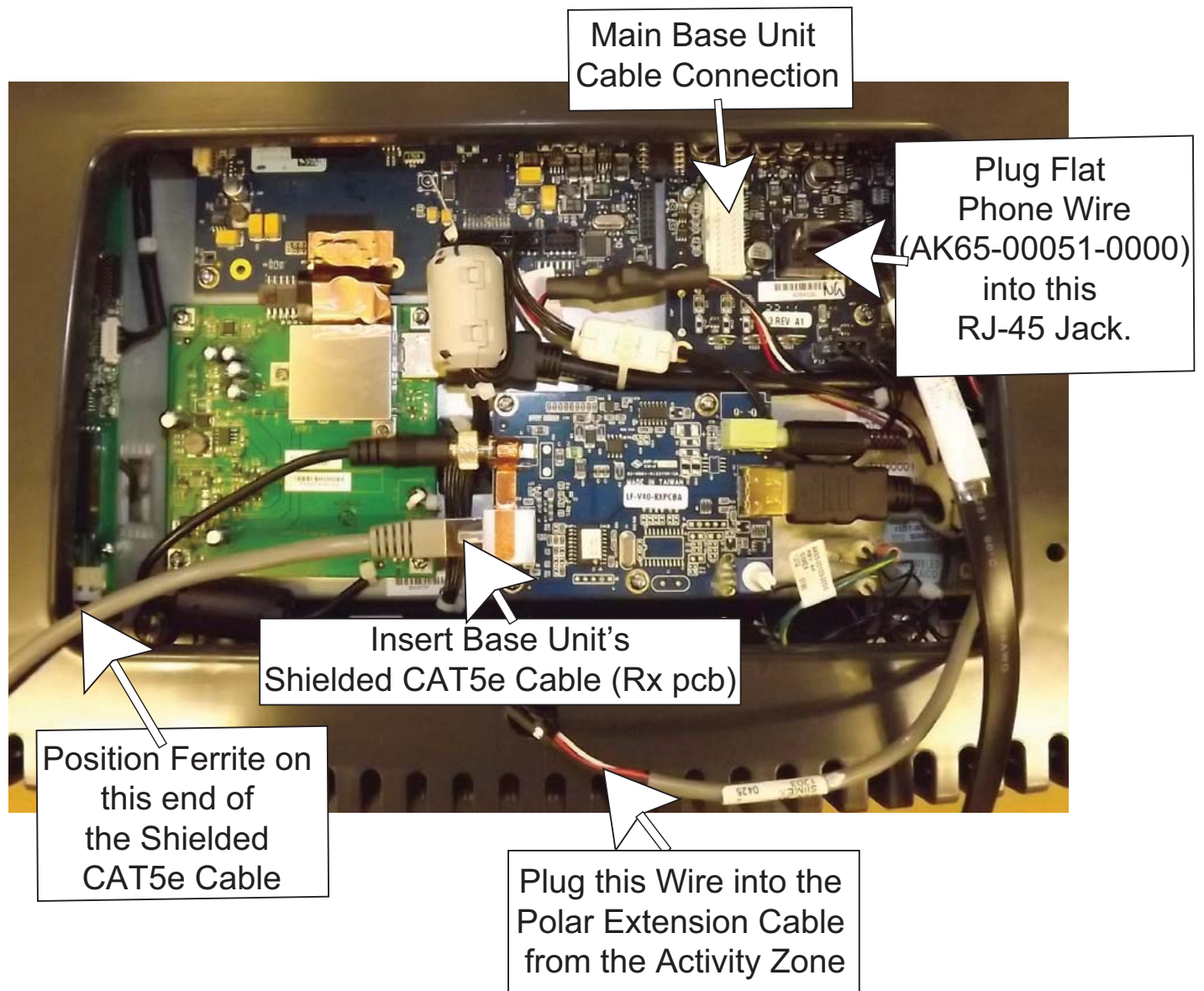

Adjust HDMI Receiver Signal Sensitivity

Installers must set the 8-position rotary switch in the console. This rotary switch adjusts the Receiver Sensitivity, “EQ”, to match the strength of the HDMI signal (which varies with distance between Transmitter and Cardio base unit).

Adjust the signal sensitivity from 7 (*default minimum sensitivity*), counterclockwise, towards 0, as shown in the picture below.

Note: To provide some margin, turn the rotary switch 1 position past the number when the audio/video plays normally.

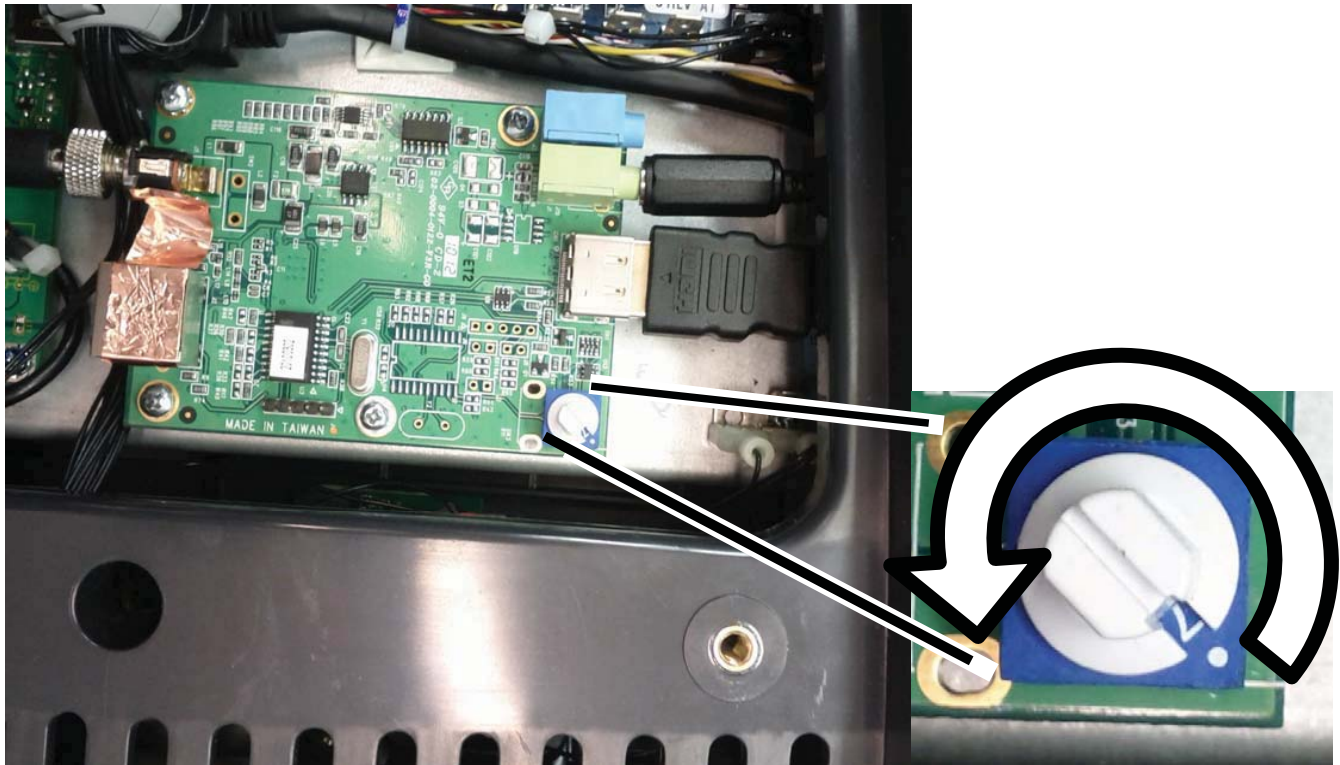

Turn the rotary switch counterclockwise from “7” to “0”.

Accessory Box (Bikes and Cross-Trainers) / Accessory Bag (Treadmills)

An accessory box comes with the IPTV Engage Consoles for Bikes and Cross-Trainers. It contains the base unit Power Supply and the following items:

Bike & Cross-Trainer (Domestic)	Bike & Cross-Trainer (International)	Bike & Cross-Trainer (Brazil)
<ul style="list-style-type: none">• 39V Power Supply• Domestic (U.S.) line cord• Dual Lock Fastener Strips• Large Cable Ties for Power Supply• Ferrite• Small Cable Ties for Ferrite• Shielded RJ-45 Coupler• Addendum	<ul style="list-style-type: none">• 39V Power Supply• Line Cords for U.K, Europe, & Australia• Dual Lock Fastener Strips• Large Cable Ties for Power Supply• Ferrite• Small Cable Ties for Ferrite• Shielded RJ-45 Coupler• Addendum	<ul style="list-style-type: none">• 39V Power Supply• Line Cord for Brazil• Dual Lock Fastener Strips• Large Cable Ties for Power Supply• Ferrite• Small Cable Ties for Ferrite• Shielded RJ-45 Coupler• Addendum

An accessory bag containing the following items comes with the IPTV Engage Console for Treadmills.

Treadmills (Domestic & International)
<ul style="list-style-type: none">• Ferrite• Small Cable Ties for Ferrite• Addendum

CONFIGURATION SETTINGS: MEDIA CENTER: TV SETUP

These commands are sent to the corresponding IPTV Set-Top Boxes.
The IPTV Set-Top-Boxes determine the actions.
See the Set-Top-Box manufacturer's documentation for detailed functionality descriptions.

